

4218400

E7298300

N218400

- GENERAL NOTES:-**
1. The Contractor shall locate and level all existing services and any adjustment will be at the Developers expense.
 2. All works to be carried out in accordance with current N.S.W. Department of Housing Specifications and Standard Drawings.
 3. 100 dia subsoil drainage lines to be provided beneath all kerb and kerb & gutter.
 4. 100 dia subsoil drainage pipe to be provided at all inlet pits, 3 m long wrapped in fabric sock adjacent to inlet pipes.
 5. Step irons to be provided to all pits deeper than 1200 mm.
 6. All kerb inlet pit grates to be cycle proof.
 7. Rock Mattress Protection to all inlet and outlet headwalls in accordance with R.T.A std dwg No MD.R1.A01.A
 7. Tail out drains from headwalls to be turfed as directed by the Superintendent.
 8. Reverse crossfall in footpaths adjacent to all low points in road.
 9. All stormwater drainage pipes 375 mm dia and greater shall be R.C. Class 2

3000 DIA CORRUGATED METAL PIPE CULVERT REFER DWG 1180/RD/27 FOR DETAILS

N218000

N218000

N217600

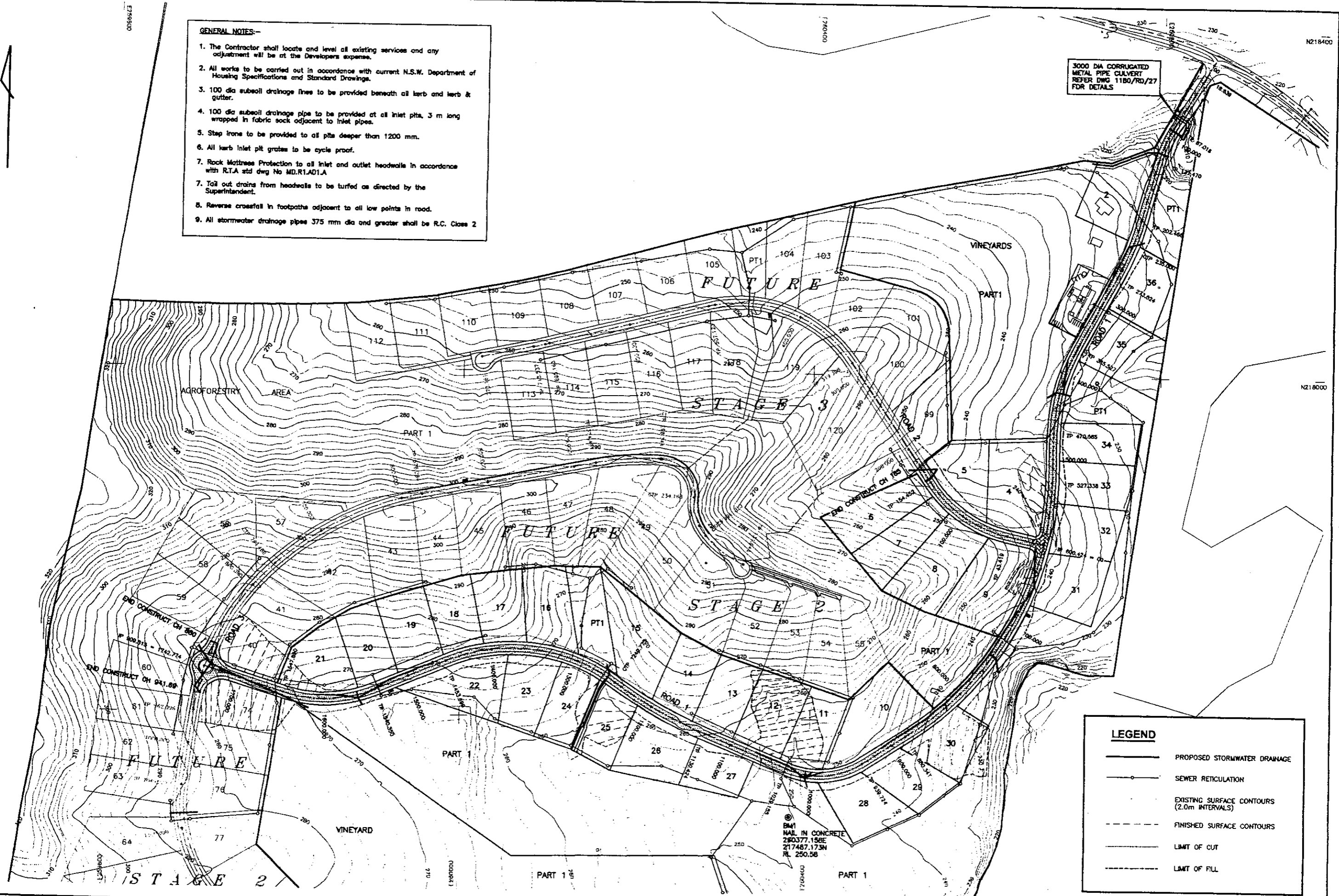

BM1
NAIL IN CONCRETE
280377.158E
217487.173N
RL 250.58

LEGEND

- PROPOSED STORMWATER DRAINAGE
- SEWER RETICULATION
- - - EXISTING SURFACE CONTOURS (2.0m INTERVALS)
- - - FINISHED SURFACE CONTOURS
- LIMIT OF CUT
- LIMIT OF FILL

DATE	DESCRIPTION
4/99	LOT NUMBERS AMENDED
7/99	AMENDED TO COUNCIL REQUIREMENTS

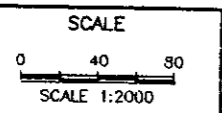

WOLLONDILLY SHIRE COUNCIL

DRAWING TITLE
GENERAL LAYOUT

DESIGNED
DRAWN
CHECKED
APPROVED

VINNICOMBE & ASSOCIATES
CONSULTING CIVIL ENGINEERS

P.O. BOX 6674
GOLD COAST MAIL CENTRE
QLD. 4217.
TEL : (07) 5595 0210
FAX : (07) 5595 0212

PROJECT
NANGARIN ESTATE - PICTON
ROADWORKS & DRAINAGE STAGE 1
for THE BRADMAN CORPORATION

DRAWING No.
1180/RD/02B

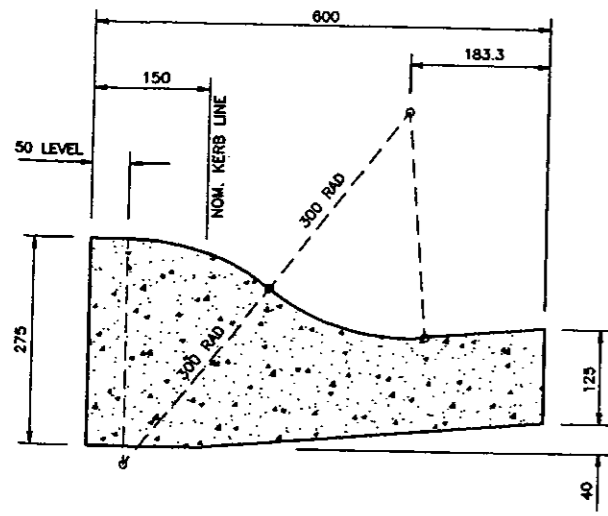

PROFILE ROLL KERB & GUTTER

- 6.0m CH00 - 60
- 7.0m CH80 - END
- 2.0m CH00 - 60
- 3.0m CH 60 - END

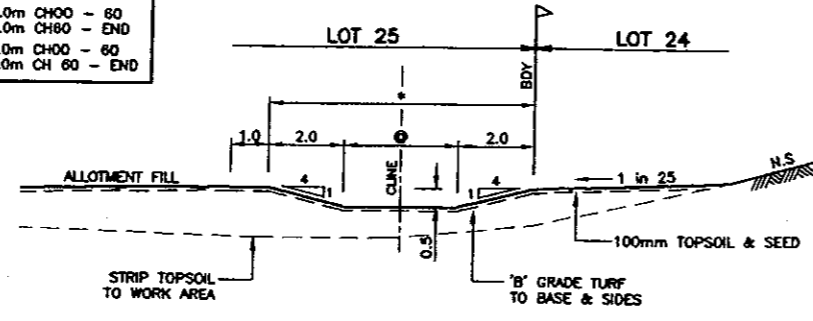

TYPICAL SECTION OVERLAND FLOW PATH
SCALE A

§ WIDTH VARIES LHS:-
6.0m - CH 16.06
4.0m - CH 36.06
REFER CONTRACT 1180-INT FOR DETAILS

PAVEMENT DETAILS
ROAD 1:-
100mm COMPACTED THICKNESS 20mm F.C.R
250mm COMPACTED THICKNESS CRUSHED SANDSTONE
(SUBJECT TO SUBGRADE TESTING)
ROADS 2 & 3:-
100mm COMPACTED THICKNESS 20mm F.C.R
200mm COMPACTED THICKNESS CRUSHED SANDSTONE
(SUBJECT TO TESTING)

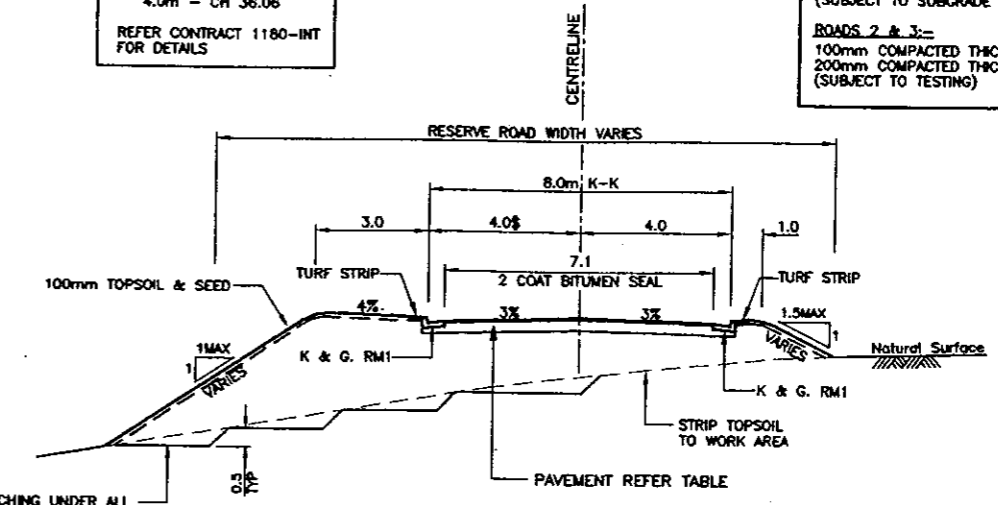

TYPICAL SECTION ROAD 1 CH 16.639 - 140
SCALE A

TYPICAL BENCHING UNDER ALL FILL WHERE NATURAL SURFACE EXCEEDS 1 in 6

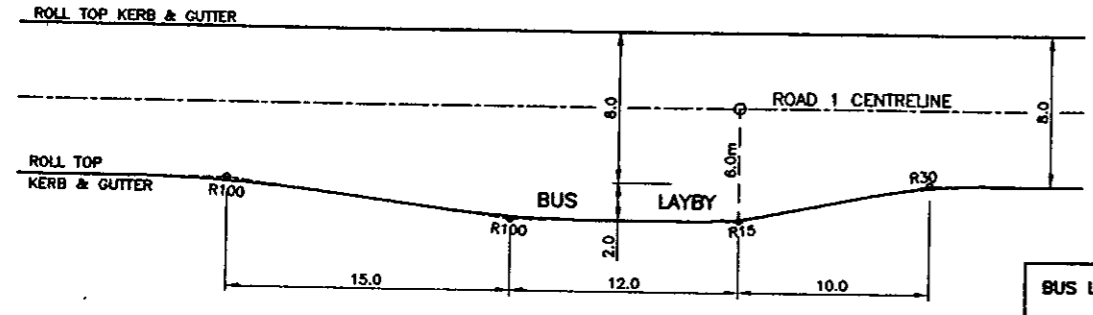

BUS LAYBY DETAIL
SCALE B
IN ACCORDANCE WITH AUSTRROADS GUIDE TO TRAFFIC ENGINEERING PRACTICE PART 11

- BUS LAYBY SETOUT CHAINAGES**
- 1 - CH 570 LHS
 - 2 - CH 1036.1 LHS
 - 3 - CH 1064.3 LHS

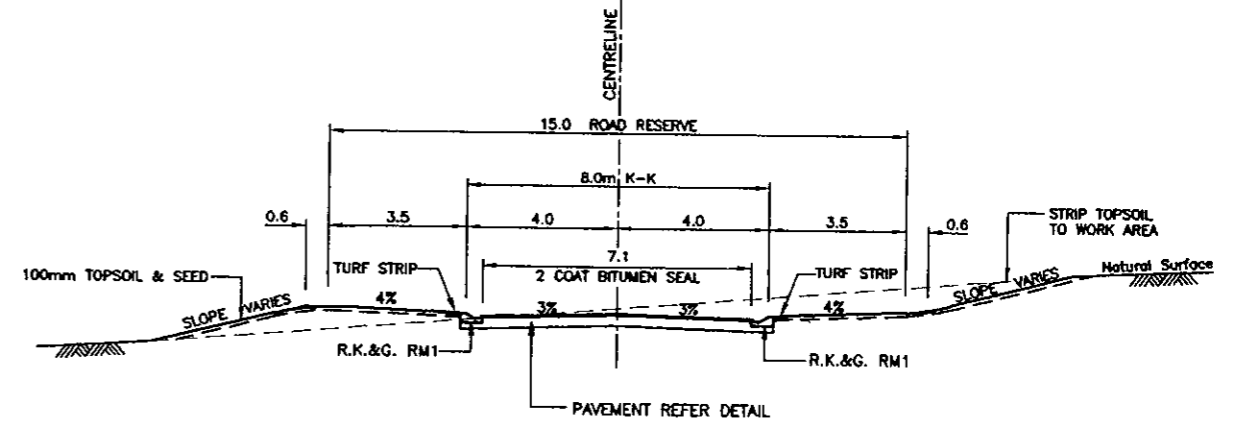

TYPICAL SECTION ROAD 1 CH 160 - END ROADS 2 & 3
SCALE A

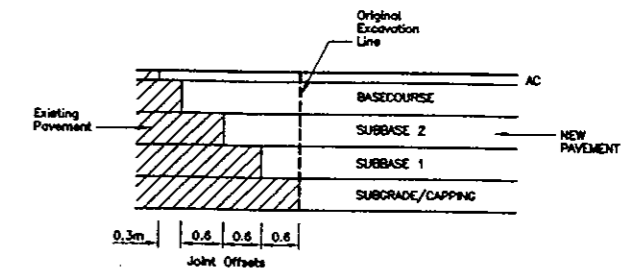

DETAIL - CONNECTION TO EXISTING PAVEMENT
N.T.S.

DATE	DESIGNED	VINNICOMBE & ASSOCIATES CONSULTING CIVIL ENGINEERS	P.O. BOX 6674 GOLD COAST MAIL CENTRE QLD. 4217. TEL : (07) 5595 0210 FAX : (07) 5595 0212	PROJECT NANGARIN ESTATE - PICTON ROADWORKS & DRAINAGE STAGE 1 for THE BRADMAN CORPORATION	DRAWING No. 1180/RD/03A
	DRAWN				
	CHECKED				
	APPROVED	WOLLONDILLY SHIRE COUNCIL DRAWING TITLE TYPICAL SECTIONS & DETAILS			
SCALES 0 1 2 3 4 SCALE A 0 2 4 6 8 SCALE B					

FOR DETAILS ON BARKERS LODGE ROAD WIDENING AND INTERSECTION DETAILS REFER CONTRACT 1180-INT DRAWING Nos 1180/INT/01 to 12

3000mm DIA CORRUGATED METAL PIPE CULVERT REFER DWG No 1180/RD/27 FOR DETAILS

300 DIA RCP STUB 5m LONG GRADE & LOCATION TO BE CONFIRMED PRIOR TO CONSTRUCTION

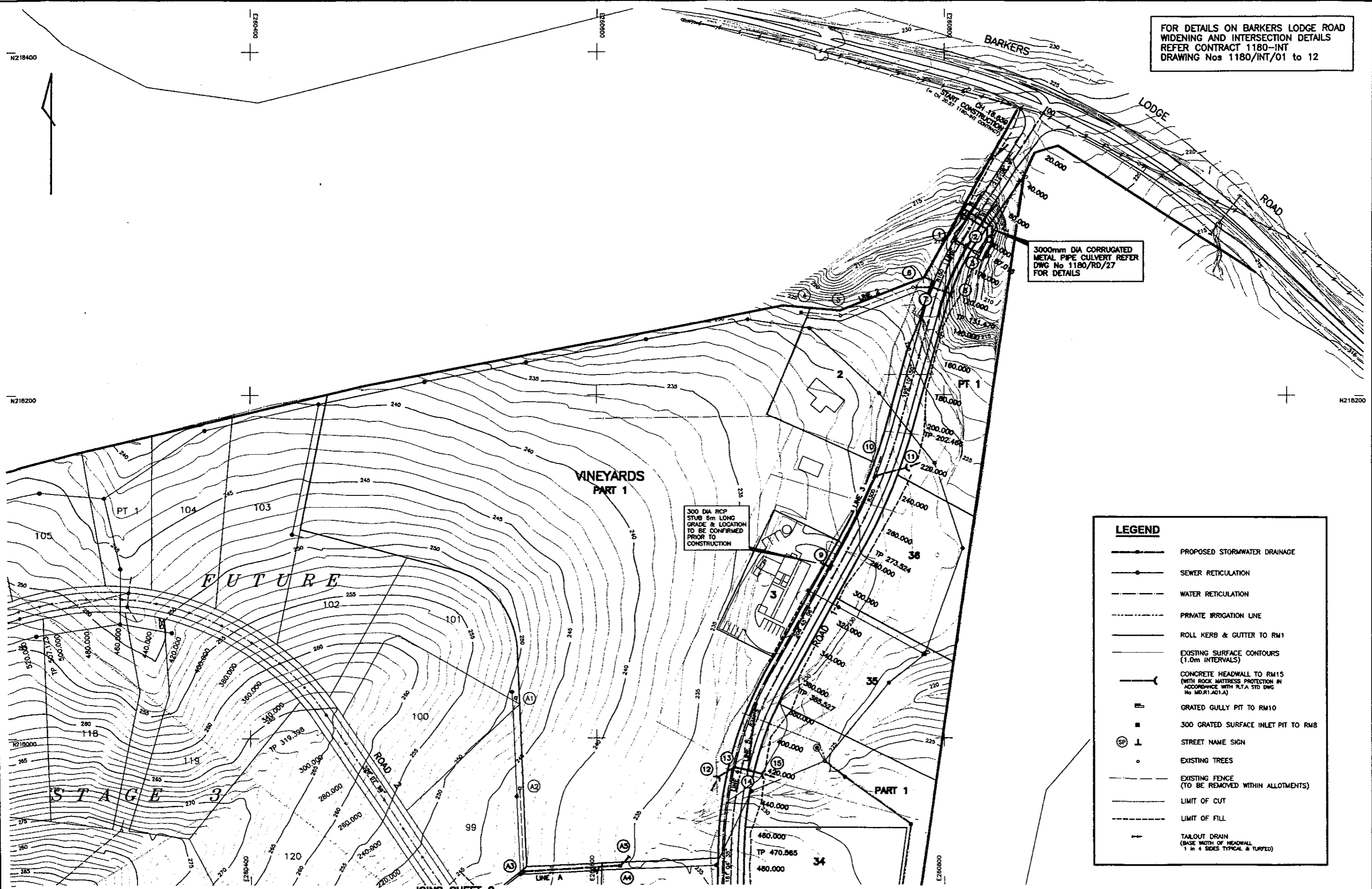

LEGEND

- PROPOSED STORMWATER DRAINAGE
- SEWER RETICULATION
- WATER RETICULATION
- PRIVATE IRRIGATION LINE
- ROLL KERB & GUTTER TO RM1
- EXISTING SURFACE CONTOURS (1.0m INTERVALS)
- CONCRETE HEADWALL TO RM15 (WITH ROCK MATTRESS PROTECTION IN ACCORDANCE WITH R.T.A. STD DWG No MD.R1.A01.A)
- GRATED GULLY PIT TO RM10
- 300 GRATED SURFACE INLET PIT TO RM8
- STREET NAME SIGN
- EXISTING TREES
- EXISTING FENCE (TO BE REMOVED WITHIN ALLOTMENTS)
- LIMIT OF CUT
- LIMIT OF FILL
- TAILOUT DRAIN (BASE WIDTH OF HEADWALL 1 in 4 SIDES TYPICAL & TURFED)

AMD	DATE	DESCRIPTION
A	4/99	LOT NUMBERS AMENDED
B	5/99	AMENDED TO COUNCIL REQUIREMENTS

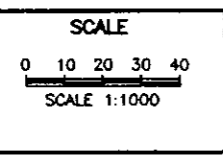

WOLLONDILLY SHIRE COUNCIL

DRAWING TITLE
ROADWORKS & DRAINAGE LAYOUT
 SHEET No 1 OF 3

DESIGNED _____
 DRAWN _____
 CHECKED _____
 APPROVED _____

VINNICOMBE & ASSOCIATES
 CONSULTING CIVIL ENGINEERS

P.O. BOX 6674
 GOLD COAST MAIL CENTRE
 QLD. 4217.
 TEL : (07) 5595 0210
 FAX : (07) 5595 0212

PROJECT
NANGARIN ESTATE - PICTON
ROADWORKS & DRAINAGE STAGE 1
 for THE BRADMAN CORPORATION

DRAWING No.
1180/RD/04B

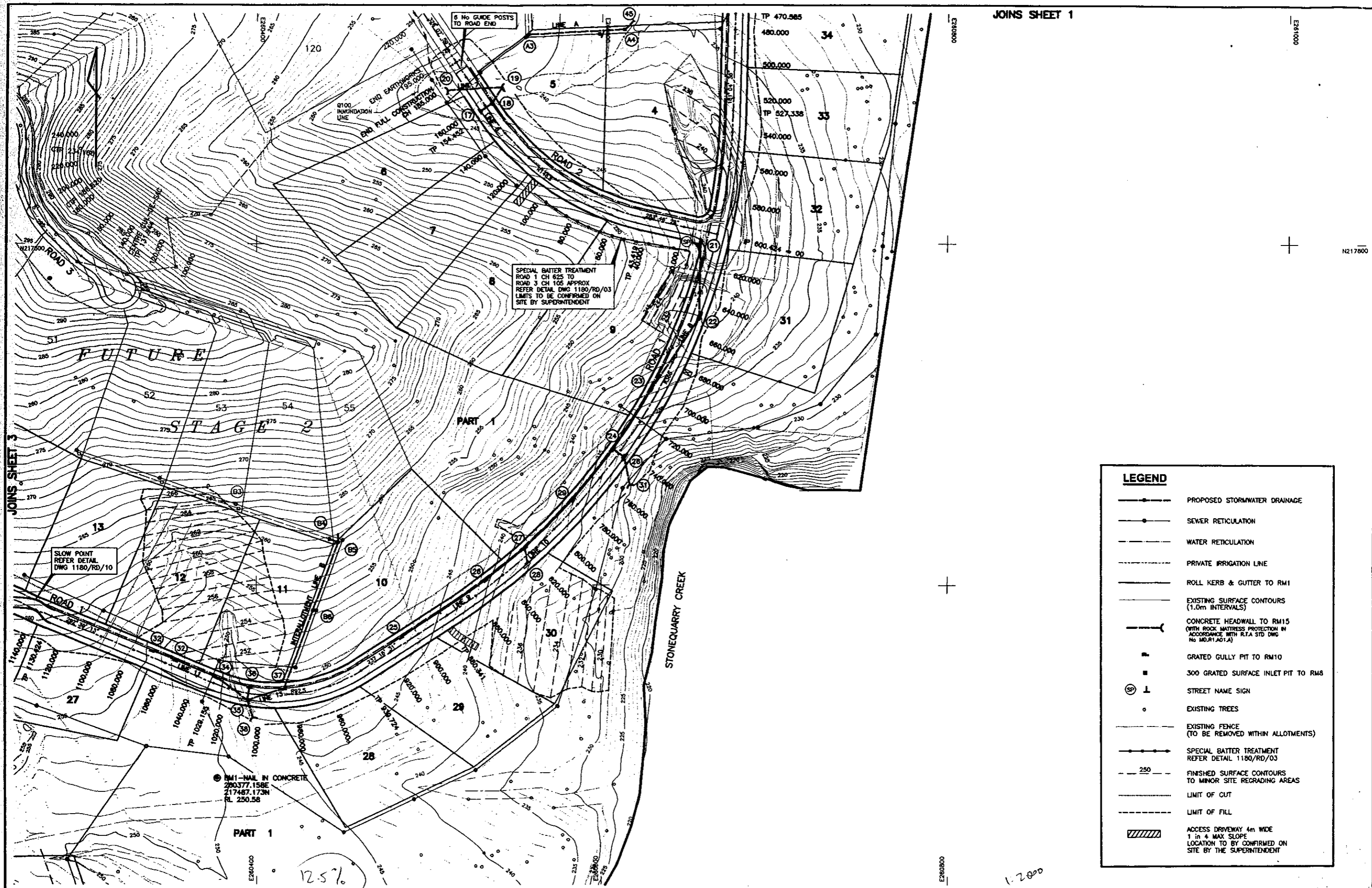

SPECIAL BATTER TREATMENT
ROAD 1 CH 625 TO
ROAD 3 CH 105 APPROX
REFER DETAIL DWG 1180/RD/03
LIMITS TO BE CONFIRMED ON
SITE BY SUPERINTENDENT

SLOW POINT
REFER DETAIL
DWG 1180/RD/10

BM1-NAIL IN CONCRETE
290377.158E
217487.173N
RL 250.58

LEGEND	
	PROPOSED STORMWATER DRAINAGE
	SEWER RETICULATION
	WATER RETICULATION
	PRIVATE IRRIGATION LINE
	ROLL KERB & GUTTER TO RM1
	EXISTING SURFACE CONTOURS (1.0m INTERVALS)
	CONCRETE HEADWALL TO RM15 (WITH ROCK MATTRESS PROTECTION IN ACCORDANCE WITH R.I.A. STD DWG No. MD.R1A01.A)
	GRATED GULLY PIT TO RM10
	300 GRATED SURFACE INLET PIT TO RM8
	STREET NAME SIGN
	EXISTING TREES
	EXISTING FENCE (TO BE REMOVED WITHIN ALLOTMENTS)
	SPECIAL BATTER TREATMENT REFER DETAIL 1180/RD/03
	FINISHED SURFACE CONTOURS TO MINOR SITE REGRAING AREAS
	LIMIT OF CUT
	LIMIT OF FILL
	ACCESS DRIVEWAY 4m WIDE 1 in 4 MAX SLOPE LOCATION TO BE CONFIRMED ON SITE BY THE SUPERINTENDENT

AMD DATE	DESCRIPTION
A 4/99	LOT NUMBERS AMENDED
B 7/99	AMENDED TO COUNCIL REQUIREMENTS

SCALE
0 10 20 30 40
SCALE 1:1000

WOLLONDILLY SHIRE COUNCIL
DRAWING TITLE
ROADWORKS & DRAINAGE LAYOUT
SHEET No 2 OF 3

DESIGNED
DRAWN
CHECKED
APPROVED













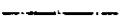
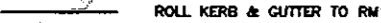

VINNICOMBE & ASSOCIATES
CONSULTING CIVIL ENGINEERS

P.O. BOX 6674
GOLD COAST MAIL CENTRE
QLD. 4217.
TEL : (07) 5595 0210
FAX : (07) 5595 0212

PROJECT
NANGARIN ESTATE - PICTON
ROADWORKS & DRAINAGE STAGE 1
for THE BRADMAN CORPORATION

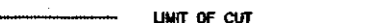
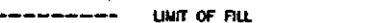
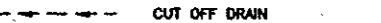
DRAWING No.
1180/RD/05B

LEGEND

-  PROPOSED STORMWATER DRAINAGE
-  SEWER RETICULATION
-  WATER RETICULATION
-  ROLL KERB & GUTTER TO RM1
-  EXISTING SURFACE CONTOURS (1.0m INTERVALS)
-  CONCRETE HEADWALL TO RM15 (WITH ROCK MATTRESS PROTECTION IN ACCORDANCE WITH R.T.A STD DWG No. MD.R1.A01.A)
-  GRATED GULLY PIT TO RM10
-  300 GRATED SURFACE INLET PIT TO RM8
-  STREET NAME SIGN
-  EXISTING TREES
-  EXISTING FENCE (TO BE REMOVED WITHIN ALLOTMENTS)
-  FINISHED SURFACE CONTOURS TO MINOR SITE REGRADING AREAS
-  LIMIT OF CUT
-  LIMIT OF FILL
-  CUT OFF DRAIN
-  SPECIAL BATTER TREATMENT REFER DETAIL 1180/RD/03
-  TAILOUT DRAIN (BASE WIDTH OF HEADWALL 1 in 4 SIDES TYPICAL & TURFED)
-  ACCESS DRIVEWAY 4m WIDE 1 in 4 MAX SLOPE LOCATION TO BE CONFIRMED ON SITE BY THE SUPERINTENDENT

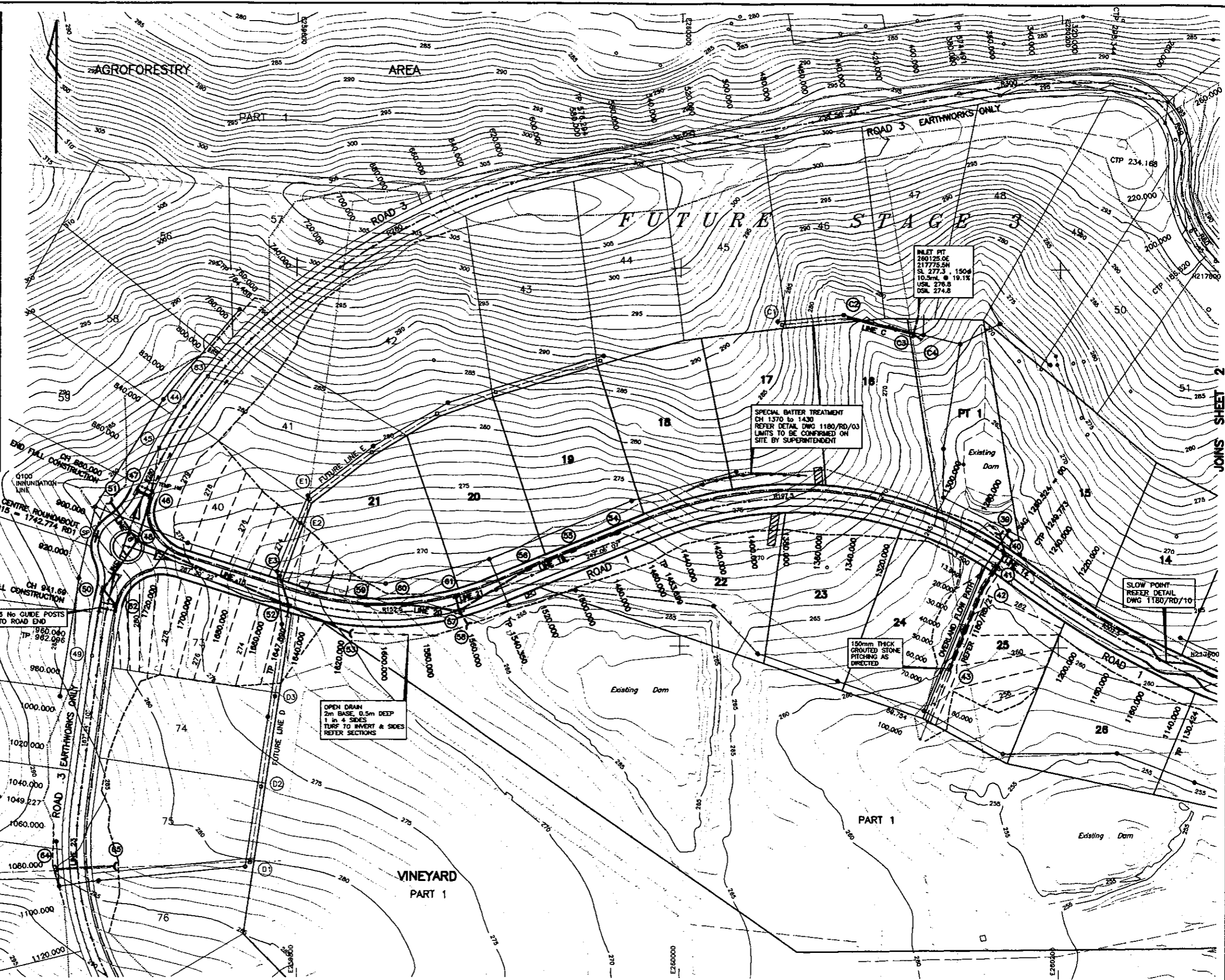

JOINS SHEET 2

AMD	DATE	DESCRIPTION
A	4/99	LOT NUMBERS AMENDED
B	7/99	AMENDED TO COUNCIL STANDARDS

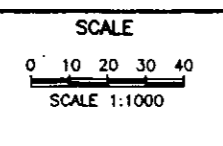

WOLLONDILLY SHIRE COUNCIL

DRAWING TITLE
ROADWORKS & DRAINAGE LAYOUT
 SHEET No 3 OF 3

DESIGNED
 DRAWN
 CHECKED
 APPROVED

 **VINNICOMBE & ASSOCIATES**
 CONSULTING CIVIL ENGINEERS

P.O. BOX 6674
 GOLD COAST MAIL CENTRE
 QLD. 4217.
 TEL : (07) 5595 0210
 FAX : (07) 5595 0212

PROJECT
NANGARIN ESTATE - PICTON
ROADWORKS & DRAINAGE STAGE 1
 for THE BRADMAN CORPORATION

DRAWING No.
1180/RD/06B

EARTHWORKS TO SUBGRADE LEVEL ONLY
ROADS CH 941.69 TO 1190
& ROAD 4 INCLUDING OVERLAND FLOW PATH

LEGEND

- WATER RETICULATION
- EXISTING SURFACE CONTOURS (1.0m INTERVALS)
- o EXISTING TREES
- EXISTING FENCE (TO BE REMOVED WITHIN ALLOTMENTS)
- LIMIT OF CUT
- LIMIT OF FILL

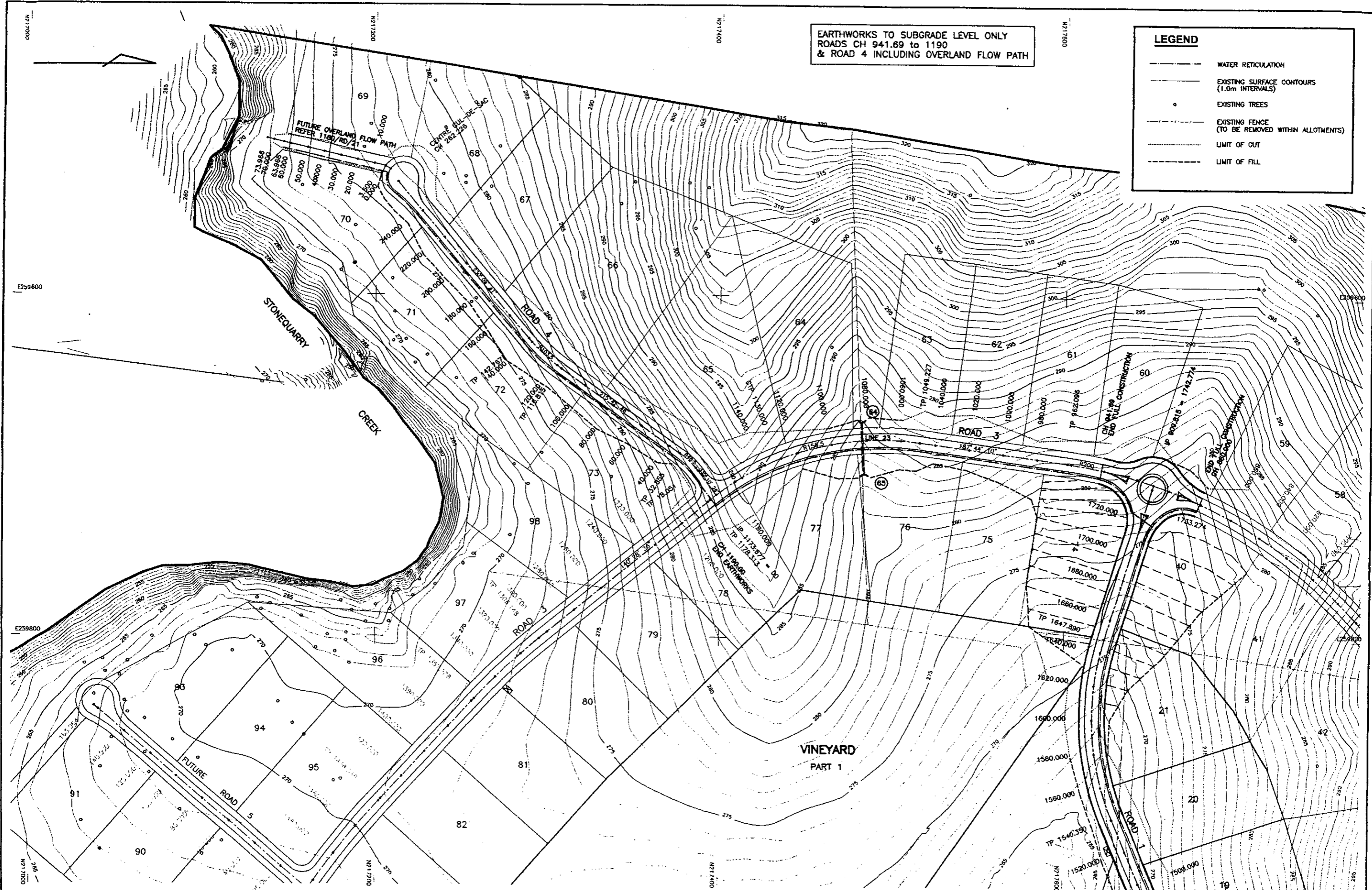

AMD DATE A 7/99	DESCRIPTION NEW DRAWING	SCALE 0 10 20 30 40 SCALE 1:1000	WOLLONDILLY SHIRE COUNCIL	DESIGNED DRAWN CHECKED APPROVED	VINNICOMBE & ASSOCIATES CONSULTING CIVIL ENGINEERS	P.O. BOX 6674 GOLD COAST MAIL CENTRE QLD. 4217. TEL : (07) 5595 0210 FAX : (07) 5595 0212	PROJECT NANGARIN ESTATE - PICTON ROADWORKS & DRAINAGE STAGE 1 for THE BRADMAN CORPORATION	DRAWING No. 1180/RD/18A
--------------------	----------------------------	--	----------------------------------	--	--	---	--	-----------------------------------